

1 Connect the receiver to the lights

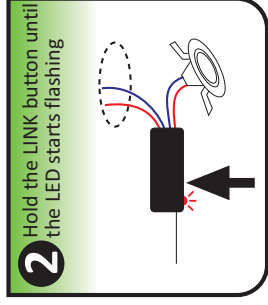

2 Hold the LINK button until the LED starts flashing

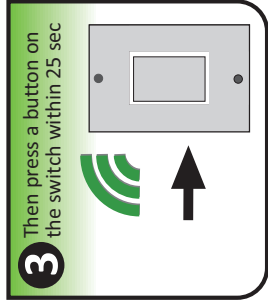

3 Then press a button on the switch within 25 sec

To unlink a button: Repeat steps 2&3.

To clear all links in a Receiver: Hold the Link Button until the LED is ON solid (10 sec) then release.

A Receiver can link up to 30 different buttons.

Mounting options: standard 2x4 mounting holes or double-sided tape

Transmitter:

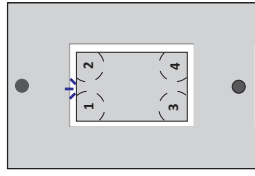

Button Operation: 4 Buttons
 Press in the marked areas "1,2,3,4"
 Press = ON/OFF
 Hold = DIM UP/DOWN

LED Indicator on button press:
 1 Flash = Normal operation
 2 Flashes = Battery Low

BATTERY REPLACEMENT

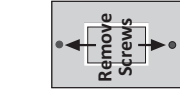

1

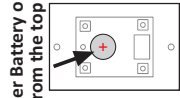

2

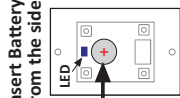

3

LED will flash 3 times to indicate successful power-up.

Dimmer:

Switch:

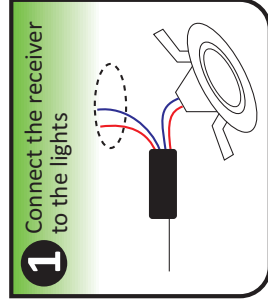
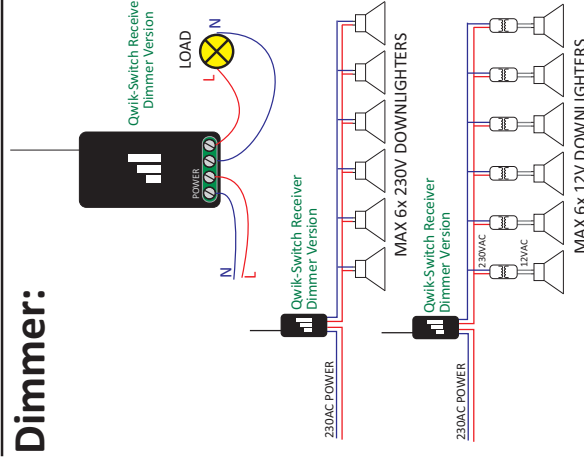

1 Connect the receiver to the lights

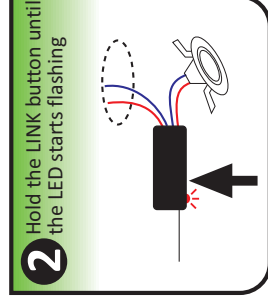

2 Hold the LINK button until the LED starts flashing

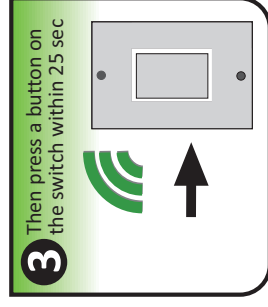

3 Then press a button on the switch within 25 sec

To unlink a button: Repeat steps 2&3.

To clear all links in a Receiver: Hold the Link Button until the LED is ON solid (10 sec) then release.

A Receiver can link up to 30 different buttons.

Mounting options: standard 2x4 mounting holes or double-sided tape

Transmitter:

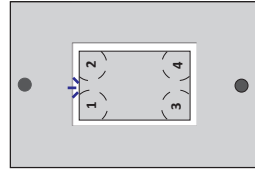

Button Operation: 4 Buttons
 Press in the marked areas "1,2,3,4"
 Press = ON/OFF
 Hold = DIM UP/DOWN

LED Indicator on button press:
 1 Flash = Normal operation
 2 Flashes = Battery Low

BATTERY REPLACEMENT

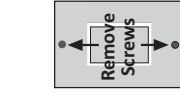

1

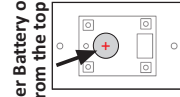

2

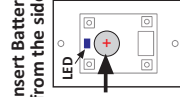

3

LED will flash 3 times to indicate successful power-up.

Dimmer:

Switch:

